

**CERTIFIED RECORD OF LAND CORNER MONUMENTATION**

USDA-FOREST SERVICE

Index File No. B-16

**CORNER RECORD (SEARCH)**  
(Ref. FSM 7151.4)

Tract or Survey No. \_\_\_\_\_

Cor. NE  
No. 1/16

T 16 S R. 34 E R.D. Prairie City County Grant

Merid. Willamette N.F. Malheur State Or.

CORNER DIAGRAM

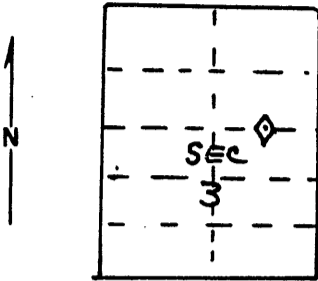

DESCRIBE CORNER MONUMENT FOUND

*NO ORIG. GLO SET.*

DESCRIBE BEARING TREES OR OTHER OFFICIAL ACCESSORIES FOUND

*NONE*

PHOTO IDENTIFICATION DATA

Photo No. \_\_\_\_\_  
Filed At. \_\_\_\_\_

**CORNER RECORD (PERPETUATION)**

MONUMENT: DESCRIBE NEW MONUMENT SET, OR WORK DONE TO PRESERVE EXISTING MONUMENT

2 1/2 " X 30" Alum. pipe with alum. cap set 22" in ground in stone mound.  
Cap stamped as shown.  
*15' W. OF SMALL BRANCH RUNNING SOUTH.*

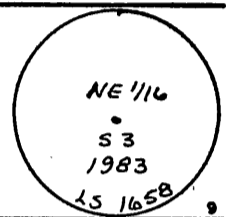

ACCESSORIES: DESCRIBE NEW BT'S WITNESS OBJECTS ETC. ESTABLISHED, OR WORK DONE TO PRESERVE EXISTING EVIDENCE

9" L.P., N49°W, 164.4' to face, 164.8' to CL, marked: "NE 1/16 S3 BT"  
13" L.P., S49°W, 84.6' to face, 85.2' to CL, marked: "NE 1/16 S3 BT"  
Steel fence post w. sign set 5' North, & 5' WEST.  
B.T.'s signed and painted.  
Small stream 15' East. Magnetic variation- 17°E

Work Done By R.H. Schulson Title Land Surveyor Date 8-83 State Registration No. #1658  
or Agency \_\_\_\_\_

Certified Cor. Record Prepared? Yes No  Filed At: \_\_\_\_\_ Date \_\_\_\_\_

REMARKS

Witnessed by: Randall Schulson

Index File No. B-16 T. 16 S R. 34 E M. Tract or Surv. No. \_\_\_\_\_ Cor. NE 1/16

SEP 16 1983

REGISTERED  
PROFESSIONAL  
LAND SURVEYOR

*Ronald H. Schulson*

OREGON  
JULY 14, 1978  
RONALD H. SCHULSON  
1658

Office of..... County Surveyor ..... County of..... Grant .....  
State of..... Oregon ....., I hereby certify that the within instrument was filed in this office  
for record on the... 22 day of... NOV ....., 1983.  
*Robert D. Bayett* by .....  
(COUNTY OFFICIAL) (DEPUTY)